

ROBINWOOD GROVE, HILLINGDON– PETITION REQUESTING A RESIDENTS PARKING SCHEME

Cabinet Member	Councillor Keith Burrows
Cabinet Portfolio	Planning, Transportation and Recycling
Officer Contact	Danielle Watson
Papers with report	Appendix A

HEADLINE INFORMATION

Purpose of report	To inform the Cabinet Member that residents of Robinwood Grove, Hillingdon have submitted a petition asking the Council to introduce 'residents only parking' in their road. This request can be considered in relation to the Council's programme for the introduction of managed parking schemes.
Contribution to our plans and strategies	The request can be considered in relation to the Council's strategy for on-street parking controls.
Financial Cost	There are none associated with the recommendations to this report.
Relevant Policy Overview Committee	Residents and Environmental Services
Ward(s) affected	Brunel

RECOMMENDATION

That the Cabinet Member for Planning and Transportation:

- 1. Discusses with petitioners their concerns with parking in Robinwood Grove.**
- 2. Subject to the outcome of the discussions with petitioners asks officers to place this request on the Council's parking programme for subsequent detailed investigation and consultation.**

INFORMATION

Reasons for recommendation

Residents are asking for a residents' parking scheme; however following further discussions with petitioners other options may be identified which may be more appropriate to address their concerns.

Cabinet Member meeting with Petitioners – 15 June 2011

Alternative options considered

The residents have made a specific request for a resident permit parking scheme. However an informal consultation with residents may allow consideration of various options for measures to control parking in their road.

Comments of Policy Overview Committee(s)

None at this stage.

Supporting Information

1. A petition with 22 signatures has been received from residents of Robinwood Grove, which represents 77% of households in the road under the following heading:

"I support the application of Robinwood Grove Residents Limited to have Robinwood Grove designated a Residents' Parking Permit Zone"

2. Robinwood Grove is a small cul-de-sac just off Royal Lane, Hillingdon. The location is indicated on the plan attached as Appendix A to this report. The road is part public adopted highway with some private off-road parking leading to a gated residential development.

3. In a covering letter to the petition it has been pointed out there is significant competition for on-street parking from non-residents associated with local hospital staff and parents with children attending Bishopshalt School.

4. The Cabinet Member will be aware that Parking Management Schemes have expanded in the areas around Brunel University and Hillingdon Hospital and many of the roads in the area benefit from managed parking. It is likely that some parking may have transferred from these areas and with Robinwood Grove's close proximity to the school and local hospital this is clearly an attractive place for non-residents to park.

5. As the road is self contained it would appear to be viable, given the level of support from residents, to introduce managed parking. Consequently it is recommended to the Cabinet Member that subject to discussions with the petitioners a proposal could be added to the Council's overall parking programme so that consultation can be undertaken with residents offering options to address non-residential parking in their road. It is acknowledged the petitioners have specifically requested the introduction of a Residents' Permit Parking Scheme but it is the Council's normal practice to offer the alternative of limited time waiting restrictions if residents consider this a viable and effective option to prevent 'all day' non-residential parking.

6. It is therefore recommended that the Cabinet Member discusses with the petitioners their concerns with parking and their possible preferences for potential solutions and adds the request to the Council's parking programme.

Financial Implications

There are no financial implications associated with the recommendations to this report.

EFFECT ON RESIDENTS, SERVICE USERS & COMMUNITIES

What will be the effect of the recommendation?

To allow the Cabinet Member to discuss in detail with petitioners their concerns with parking in Robinwood Grove and explore possible options that could be introduced to address their issues.

Consultation Carried Out or Required

None at this stage

CORPORATE IMPLICATIONS

Legal

There are no special legal implications for the proposal, which amounts to an informal consultation.

Should there be a decision that further measures are to be considered then the relevant statutory provisions will have to be identified and considered.

In considering any informal consultation responses, decision makers must ensure there is a full consideration of all representations arising including those which do not accord with the officer recommendation. The decision maker must be satisfied that responses from the public are conscientiously taken into account.

Corporate Landlord

The report has no property implications and the Corporate Landlord has no comments.

BACKGROUND PAPERS

Petition dated – 2nd September 2010

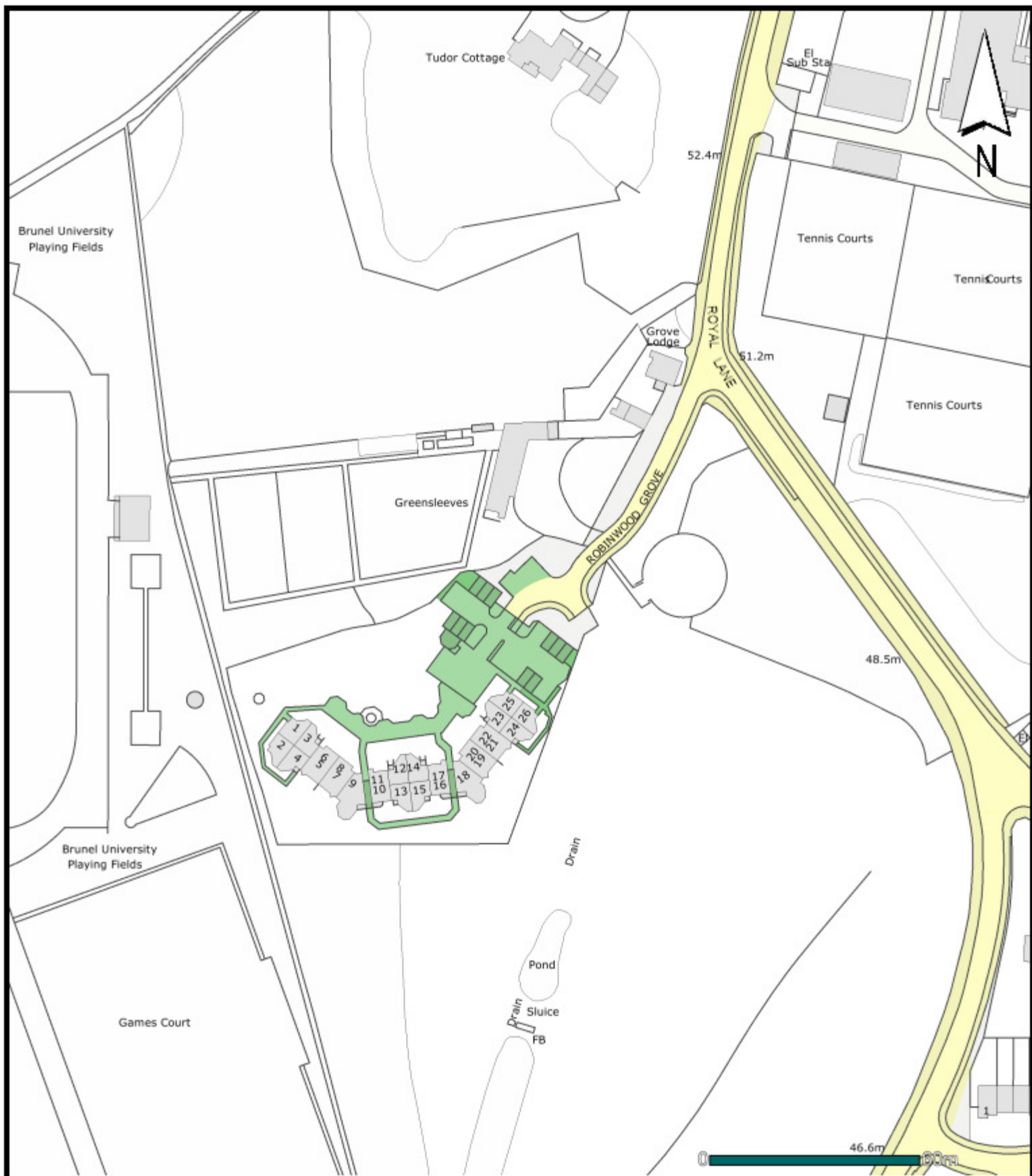

Robinwood Grove - Location Plan

Appendix A

Date November 2010

Scale 1:1,500